

rainbow[®]
POWERNOZZLE™

INSTRUCTION MANUAL



Important Safety Instructions

WARNING:

1. Use only as described in this manual. Use with RHCS19 Rainbow model only.
2. To reduce the risk of electric shock - use indoors only.
3. To avoid the risk of fire, do not vacuum up anything that is burning or smoking, such as cigarettes, matches or hot ashes.
4. To avoid electric shock, do not handle plug or Power Nozzle with wet hands.
5. To avoid injury, do not put any object into openings. Do not use if any openings are blocked; keep free of dust, lint, hair, and anything that may reduce airflow.
6. To avoid injury, keep hair, loose clothing, fingers and all parts of body away from openings and moving parts.
7. To reduce the risk of electric shock - use for dry pick up only. Do not use Power Nozzle outdoors or on wet surfaces.
8. To reduce the injury from moving parts, unplug from the electric supply before cleaning or servicing.
9. This Power Nozzle utilizes double insulation. Use only identical replacement parts. See instructions for servicing double insulated appliances.
10. A double-insulated appliance is marked with one or more of the following: the words "DOUBLE INSULATION" or "DOUBLE INSULATED," or the double insulation symbol (square within a square). In a double-insulated appliance, two systems of insulation are provided instead of grounding. No grounding mechanism is provided on a double-insulated appliance, nor should a means for grounding be added to the appliance. Servicing of a double insulated appliance requires extreme care and knowledge of the system, and should only be done by qualified personnel. Replacement parts for a double-insulated appliance must be identical to the parts they replace.
11. To avoid the risk of fire, do not use to pick up flammable liquids, such as gasoline, or use in areas where they may be present.
12. The Rainbow can be used by children aged 8 years and above and persons with reduced physical, sensory, or mental capabilities or lack of experience and knowledge, if they have been given supervision or instruction concerning use of the Rainbow in a safe way, and if they understand the hazards involved. Children should be supervised to ensure that they do not play with the Rainbow. Cleaning and user maintenance shall not be performed by children without supervision.
13. Never pick up hard or sharp objects with the Power Nozzle. Items such as pins, hairpins, tacks, crayons and pencil stubs may cause damage to the brush roll or belt.
14. Always make sure your Rainbow is unplugged before attaching your Power Nozzle.
15. Do not oil motor. The motor is permanently lubricated and sealed.
16. Consult flooring manufacturer prior to using the Power Nozzle on bare hard surfaces. Then test the Power Nozzle in an inconspicuous location to verify the flooring is not damaged by use.
17. The Power Nozzle is NOT for use on polished or glossy finish hard surface floors. Additionally, when TRANSPORTING the power nozzle across polished or glossy finish hard surface floors, the Power Nozzle should NOT be running AND the wands should be placed in the upright lock position AND the Power Nozzle tipped back on its rear two wheels for transportation across polished or glossy finish hard surface floors.
18. WARNING: Disconnect electrical supply before performing maintenance to the unit. Failure to do so could result in electrical shock or personal injury.



THIS SYMBOL MEANS 'CAUTION.' When using an electrical appliance, basic precautions should always be followed, including the following:



THIS SYMBOL MEANS 'PLEASE READ ALL INSTRUCTIONS BEFORE USING THIS UNIT.'

SAVE THESE INSTRUCTIONS

THE POWER NOZZLE IS INTENDED FOR HOUSEHOLD USE ONLY.
USE THE POWER NOZZLE ONLY AS DIRECTED IN THIS OWNER'S MANUAL
USE THE POWER NOZZLE WITH MODEL RHCS19 RAINBOW ONLY

The Rainbow® Power Nozzle™

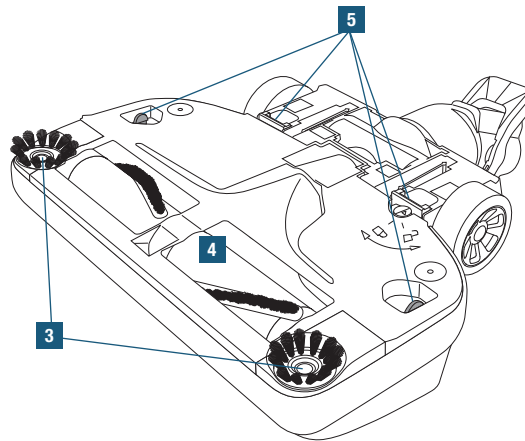
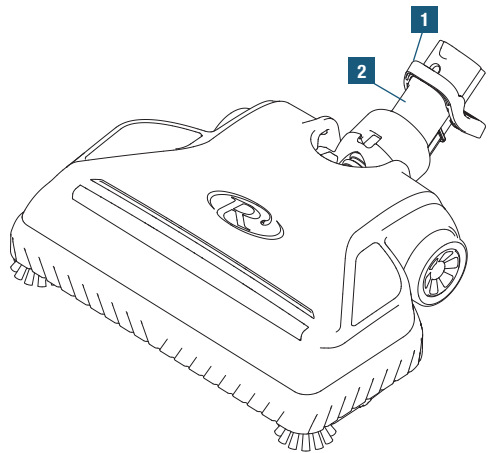

1. Foot Release
2. Pivot Arm
3. Active Edge Cleaning Brushes
4. Brush Roll
5. Sole Plate Release Tabs

Contact an Authorized Rainbow Distributor for replacement Power Nozzle belts and other supplies.

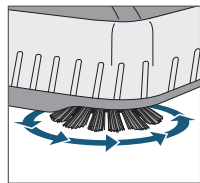

Active Edge Cleaning...

The Rainbow Power Nozzle features active brush edge cleaners on both sides. Guide either side of the Power Nozzle along baseboards or next to furniture to help remove dirt trapped along carpet edges.

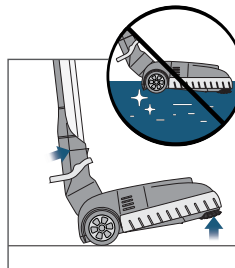

Polished or Glossy Finish Hard Surface

⚠ CAUTION: The Power Nozzle is NOT for use on polished or glossy finish hard surface floors.

Additionally, when TRANSPORTING the Power Nozzle across polished or glossy finish hard surface floors, the Power Nozzle should NOT be running AND the wands should be placed in the upright lock position AND the Power Nozzle tipped back on its rear two wheels for transportation across polished or glossy finish hard surface floors.

Troubleshooting Guide

This Rainbow appliance has been thoroughly tested and inspected. If a minor issue develops, the following troubleshooting procedures may help identify and correct the issue. If you are unable to resolve the issue, contact an Authorized Rainbow Distributor for service. Any service procedure not listed below should be performed by an Authorized Rainbow Distributor or Service Center.

⚠ WARNING: Disconnect electrical supply before performing maintenance to the unit. Failure to do so could result in electrical shock or personal injury.

ISSUE	POSSIBLE CAUSE	POSSIBLE SOLUTION
The Power Nozzle motor is not running.	Handle trigger is not activated.	Must squeeze trigger on hose handle.
	Wands not connected.	Make sure wands are properly connected.
	Wand connections not made.	Make sure wands are seated properly.
	Automatic resetting motor protector has tripped.	Turn Rainbow off. Leave off for 30 seconds. Turn Rainbow back on.
The Power Nozzle motor is running but brush is not revolving.	Broken belt.	Disconnect power; Remove sole plate; Make sure brush rotates freely; Replace belt.
The Power Nozzle brush is stopped and cannot be rotated by hand.	Object lodged in brush chamber.	Disconnect power; Remove sole plate; Remove foreign object; Make sure brush rotates freely.
	Bearing worn out.	Contact an Authorized Rainbow Distributor or Service Center for a replacement brush roll.
The Power Nozzle is not picking up debris well.	Clogged air chamber.	Disconnect power; Remove sole plate; Clear out entire air chamber.
	Clogged wands or hose.	Disconnect power; Remove obstruction; Connect to Rainbow; Make sure air is flowing freely through hose.
	Bristles not in contact with carpet.	Make sure sole plate is completely in position before latching; Replace brush if bristles are worn too short.

Power Nozzle™ Assembly and Operation

Assembly

1. Prior to using the Power Nozzle, follow the Rainbow Quick Start Guide to prepare the Rainbow.
2. Insert the bottom wand with male end into the opening located on top of the Power Nozzle. Press downward until button lock clicks.
3. To lock Power Nozzle into the upright position, grasp the wand assembly and push forward until wand system is fully engaged in locking tabs.
4. To disconnect the Power Nozzle from the wand, place your foot on the foot release above the pivot arm.

Operation

3. Plug in the Rainbow.
4. Press down on the main power button. The Rainbow will always start in high speed.
5. To disengage from the upright position, use your left foot to press down on the top of the Power Nozzle. Then pull backwards.
6. To activate the Power Nozzle, squeeze trigger on hose handle. Release trigger to turn Power Nozzle off.
7. Guide Power Nozzle slowly back and forth over carpet with free and easy strokes. Let the Power Nozzle and Rainbow do the work.

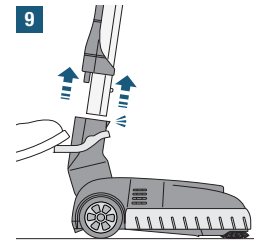
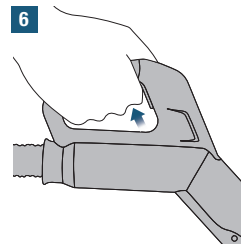
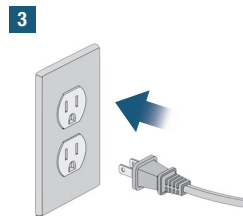
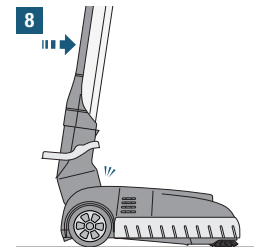
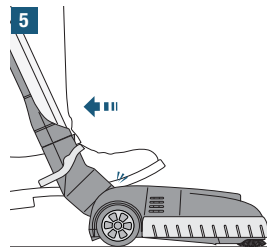
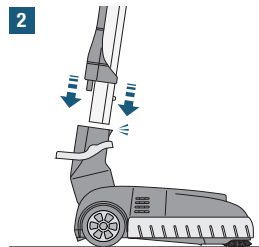
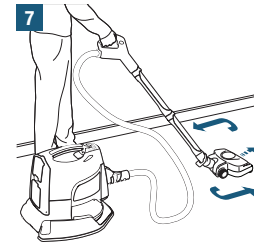
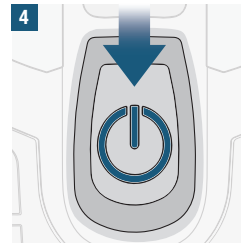

Replacing the Power Nozzle™ Belt

For best performance, we recommend you replace your Rainbow Power Nozzle belt every 12 to 18 months, or when you notice decreased cleaning performance. Your Power Nozzle comes with one replacement belt, and can be easily changed in just a few minutes. This replacement belt is located in the spare belt pocket under the sole plate. For additional replacement belts, contact an Authorized Rainbow Distributor.

⚠ WARNING: Always disconnect from electrical supply when servicing.

1. Turn the Power Nozzle upside down. Using a flat-bladed screwdriver or coin, turn the fastener a quarter-turn to the left (counterclockwise).
2. Using both thumbs, push tabs on both sides of sole plate outward while lifting to unlock.
3. Next, insert index fingers into two side openings near wheels. Pull side tabs up while pushing in to lift off sole plate.
4. Rotate brush roll assembly forward (note that edge cleaning brushes are upside down) and remove.
5. a) Slide worn or broken belt off motor shaft with finger; b) Lift brush roll out and remove worn belt.
6. Place new belt over the end of brush roll assembly. Position new belt around the pulley.
7. a) Place brush roll upside down with edge cleaning brushes centered on top of two side tabs. Slide belt over end of motor shaft; b) Rotate brush roll assembly forward until edge cleaning brushes are face up. Spin brush roll toward you to position the belt on the center of the pulley.
8. Position sole plate over top of Power Nozzle cover. Press down until front, two side tabs and back tabs snap and lock in.
9. Using a flat-bladed screwdriver or coin, turn the fastener a quarter-turn to the right (clockwise) to lock sole plate. Assembly is complete.

1

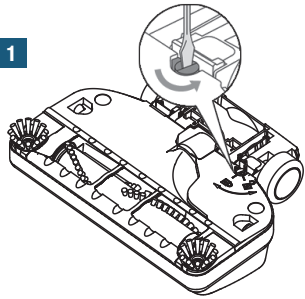

2

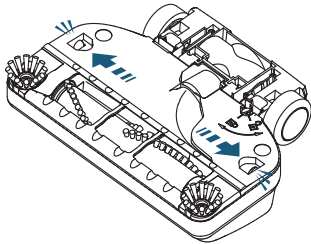

3

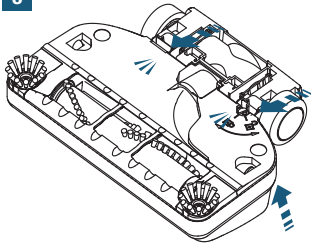

4

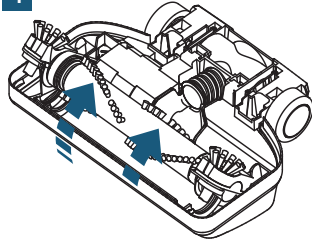

5A

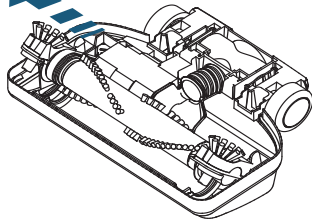

5B

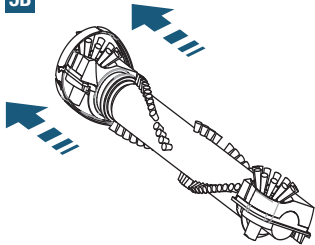

6

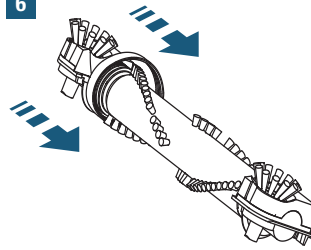

7

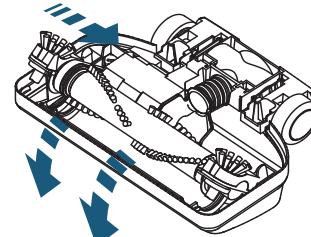

8

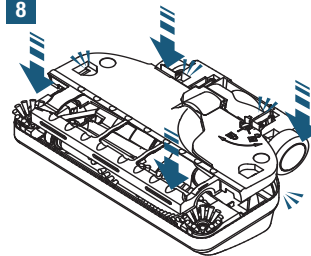

9

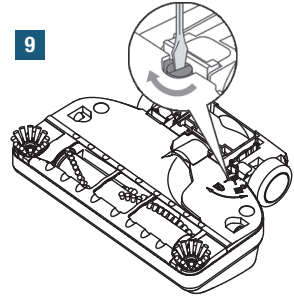

Customer Care Number

As part of Rexair's Customer Care program, each Power Nozzle receives a Customer Care serial number only after passing Quality Control assurance testing. This serial number provides:

- ✓ Ownership identification for you
- ✓ Warranty identification for your Distributor
- ✓ Assurance of passing Quality Control testing
- ✓ Assurance of "factory-fresh" condition

For future reference, record the serial number in the space provided below. No authentic, new Power Nozzle should be sold without this number. If the serial number is missing, Rexair makes no claim as to the origin, age, or condition of the unit. If you are unable to locate a serial number on your Power Nozzle, please contact Rexair's customer service department.

POWER NOZZLE SERIAL NUMBER

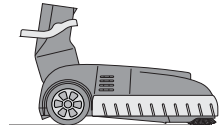

YOUR AUTHORIZED RAINBOW DISTRIBUTOR

NAME		 Contact your local Authorized Rainbow Distributor for advice on caring for your Power Nozzle, warranty coverage, replacement parts and service information.
ADDRESS		
CITY/STATE/POSTAL		
PHONE		
E-MAIL		

Rexair^{LLC}

2600 W. Big Beaver Road, Suite 555 | Troy, Michigan 48084 | USA
(248) 643-7222 | custserv@rexairllc.com | rainbowsystem.com

© 2024 Rexair LLC, all rights reserved. Rainbow®, SRX®, RainbowMate®, MiniJet®, JetPad®, RainMate®, RainJet®, AquaMate®, Rexair®, Hurricane®, The Power of Water®, Wet Dust Can't Fly® and the configuration of the Rainbow® Cleaning System are registered trademarks of Rexair LLC, Troy, Michigan, United States.

Blank lined writing area consisting of 15 horizontal blue lines.



rainbowsystem.com

Rexair LLC | Troy, Michigan
© 2024 Rexair LLC | R18252A-1