



Rainbow

AquaMate

Carpet Cleaning Extraction Unit

A revolutionary new method of carpet cleaning which gives professional results and leaves your carpets beautifully clean.

REMOVES DIRT — GRIME — SPOTS

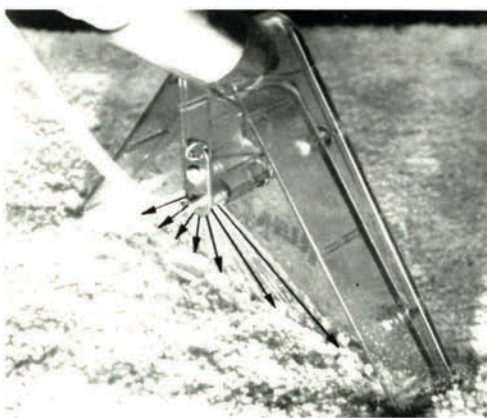

SPRAYS SOLUTION INTO CARPET

Power sprays hot cleaning solution deep into carpet.

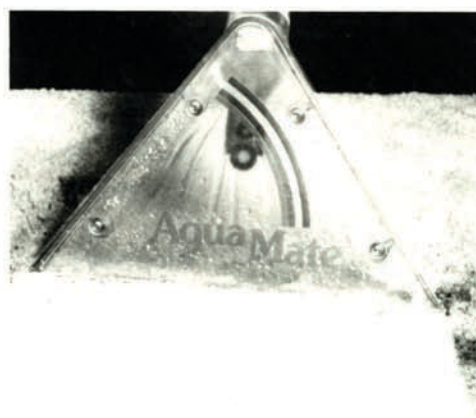

RAINBOW POWER REMOVES MOISTURE

Rainbow's wet pick-up feature*, plus high volume airflow removes moisture from carpet.



EASY TO USE

No special equipment needed. Will hook up right to your Rainbow.

*Refer to your Rainbow Operations Manual to verify wet pickup capability.

AQUAMATE CARPET CLEANING FORMULA

AquaMate's unique Carpet Cleaning Formula combines ease of operation, superior cleaning results and economy.

CLEANER
DEODORIZER



RECONDITIONS
PROTECTS

ALL IN ONE

- * **CLEANER**
Powerful cleaner for removing most stains and loosening embedded dirt.
- * **RECONDITIONER**
Helps remove residual detergents from previous shampooing.
- * **DEODORIZER**
Leaves carpet fresh and clean smelling.
- * **PROTECTOR**
Conditions carpet with a protective coating to help guard against resoiling.

WARNING

The AquaMate by Rexair, Inc. is designed to be used with Rainbow model numbers D2A, D3, D3A, D3B, D3C. Model numbers can be verified on the serial name plate on the inside of the Rainbow main housing. Should you still have any further questions, please contact your registered Rainbow distributor. **Do not** use the AquaMate with a Rainbow that is not listed above or other vacuums unless approved for wet/dry pick-up.

ANY OTHER USAGE MAY RESULT IN SEVERE ELECTRICAL SHOCK.

IMPORTANT SAFEGUARDS

Please read and follow all instructions concerning hazards of electricity outlined in your Rainbow Operation Manual.

SET-UP

1. Insert Rainbow hose into the suction end of your Rainbow unit. **Water basin should be empty before starting to clean.** Please also refer to Wet Pick-Up instructions in the back of your Rainbow Operation Manual.
2. Attach plastic extension wands and bottle injector assembly together.
3. Attach floor suction tool to the base of the extension wands.
4. Push the end of the thin tube over the brass nozzle on the floor suction tool.
5. Push the thin tube into retainer slot on the back side of the extension wands.

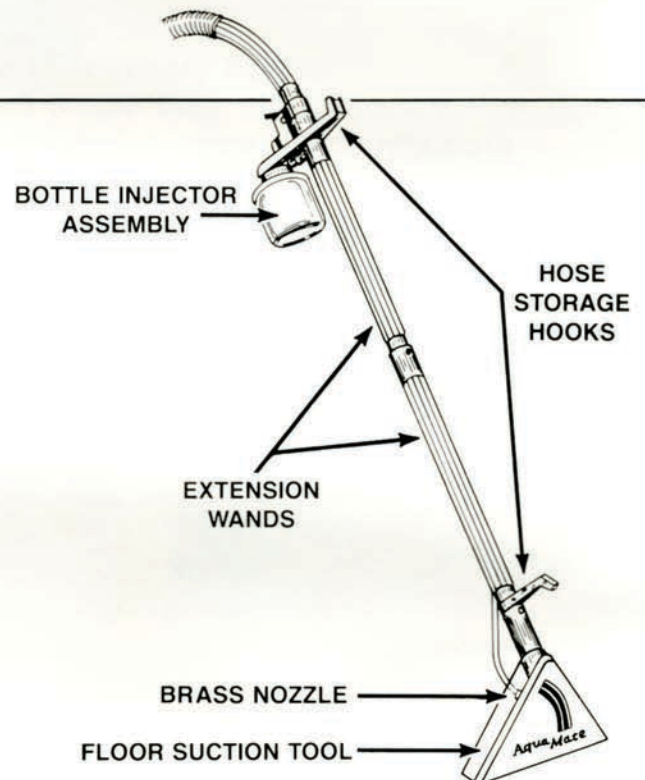

OPERATION

1. Preparation - First vacuum carpet thoroughly, then you are ready to use your AquaMate.
2. Remove injector bottle and pour AquaMate Carpet Cleaning Formula to the fill line. Fill remainder of bottle with water. Note: AquaMate Carpet Cleaning Formula can be purchased separately from your registered Rainbow distributor.
3. Attach the water hose to any threaded kitchen or bathroom faucet. Some faucets have external threads and others have internal threads. Most have aerators or screen filters that unscrew. Unscrew the aerator. If pliers are necessary, wrap the aerator with tape to avoid damage. If an adapter is necessary, (see diagram B) screw it to the faucet. Screw the water hose to the adapter. This should be done carefully and slowly to avoid damaging threads. If you must connect to a laundry type thread, an adapter can be purchased separately. There are also adapters available that will attach to threadless faucets called pos-a-grip adapters.
4. Set your faucet between warm and hot. Extreme hot water could damage the system and carpet. Run water prior to attaching hose to avoid cold water start. A washer is provided on the hose to prevent drips.
5. Plug in the Rainbow electrical cord to a wall receptacle and you are ready to clean your carpets!
6. Prior to cleaning room, heavily soiled areas should be prespotted. This can be done by releasing cleaning solution spray with the release trigger, holding the wand approximately 6 inches over the heavily soiled areas. This operation can be done without the Rainbow running, using only the water pressure from your faucet. Once you have prespotted the heavily soiled areas, you can then proceed to clean the entire room as directed.

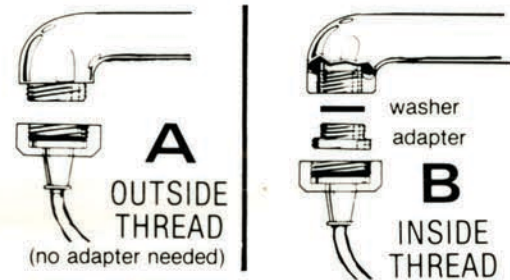

7. Turn on power by the off-on switch on the Rainbow unit.
8. Place the floor suction tool on the carpet and with one hand engage the injector trigger releasing the spray of cleaning solution and hot water into your carpet. Pull the unit toward you so that the Rainbow picks up the dirty water.
9. A slight back and forth scrubbing will help loosen spots. Prespot traffic areas with quick initial pass, then clean entire room. A final pass over the carpet with the Aqua Mate will help the carpet dry faster. Faucet or water supply should be turned off.
10. **Each time you refill the injector bottle, you should empty the liquid waste in the Rainbow water basin.** Water pick-up capacity of the Rainbow unit is two quarts. Additional volume beyond the two quarts will cause your Rainbow to overload. **If the Rainbow unit begins to make a noise or rock, turn unit off immediately and empty water basin.**
11. When finished with the cleaning job, clean the water basin and wands before storing. Rinse the parts with water. **IMPORTANT: AFTER EACH USE RINSE BOTTLE. FILL WITH CLEAN WATER AND OPERATE THE INJECTOR TO FLUSH SYSTEM.** This should be done by holding the floor suction tool over sink or bucket. To dry the wands and the hose, attach hose end to the exhaust of the Rainbow unit and run for 5 or 10 minutes. Please refer to Proper Care For Long Life Of The Rainbow outlined in the Rainbow Operation Manual.
12. When unit is clean & dry, store water hose on hooks provided.



800-523-0510

www.rainvac.com

TROUBLE SHOOTING

1. **Trouble:**
Unit stops spraying or stops injecting cleaning solution.
2. **Possible Cause:**
 - No water pressure.
 - Obstruction in bottle.
 - Obstruction in spray nozzle.
 - Obstruction in injector unit.
3. **Remedy:**
 - Check faucet to be sure you still have water pressure supplied to the unit.
 - Check the bottle.
 - a) Be sure that the bottle vent hole is open (Rubber gasket might be stuck.)
 - b) Pull off tube (inside bottle) and clean out small hole.
 - Check the spray nozzle on the floor tool. Clean off any build-up. Pull off tube and run clean-out tool through hole if necessary.
 - Check injector unit. Unscrew and remove trigger cover. Unscrew cap in front of trigger injector assembly. Clean out holes in both injector and housing.
4. **To Clean Spray Nozzle:**
A nozzle clean-out tool is provided. See below.

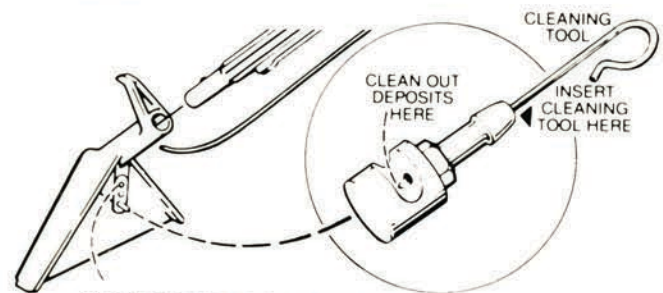

YOUR NOZZLE CLEAN-OUT TOOL IS STORED HERE.

For any additional information or assistance write to:

REXAIR, INC.
900 Tower Drive, Suite 700 • P.O. Box 3610
Troy, Michigan 48098